

# Pultrudados, Derivações e Tampas

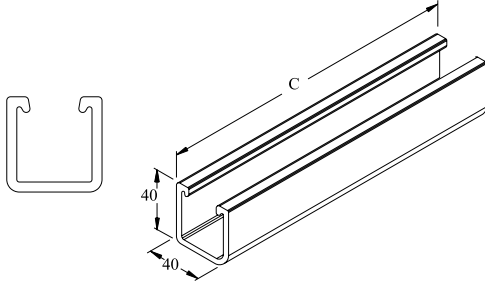

## Pultrudado "U" Liso ENMAC

PLE



### Como Especificar



## Pultrudado "U" Perfurado ENMAC

PPE

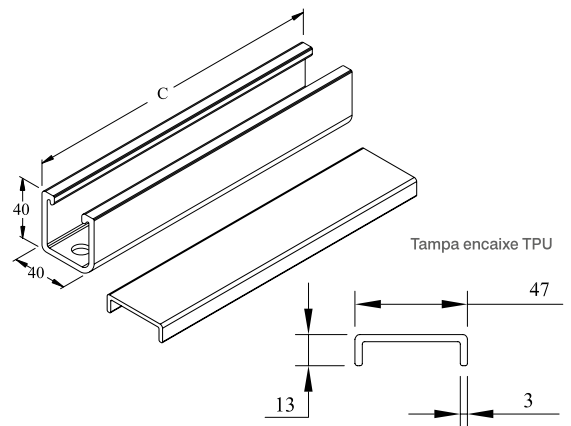

## Derivações e Acessórios

### Como Especificar

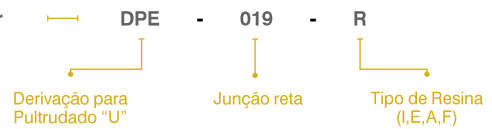

### Curva Horizontal 90°

REF.:DPE-003

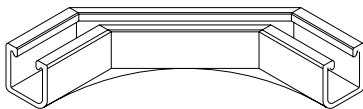

### Curva Horizontal 45°

REF.:DPE-004

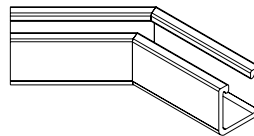

### Curva Vertical Interna 90°

REF.:DPE-011

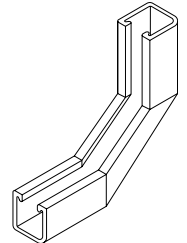

### Curva Vertical Interna 45°

REF.:DPE-012

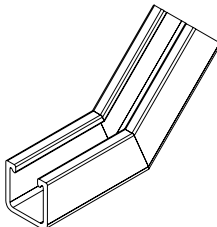

### Curva Vertical Externa 90°

REF.:DPE-009

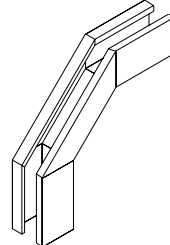

### Curva Vertical Externa 45°

REF.:DPE-0010

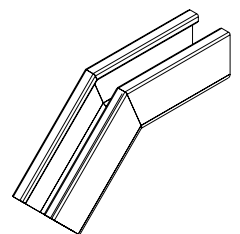

### Curva de Inversão

REF.:DPE-013

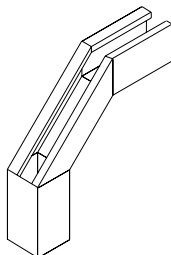

### Tampa Para Curva Horizontal 90°

REF.:TPU-003

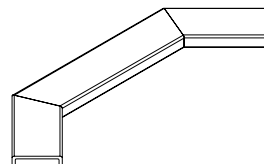

### Tampa Para Curva Horizontal 45°

REF.:TPU-004

